

ARMÁRIO COM PORTA DE CORRER  
esc.: 1/25

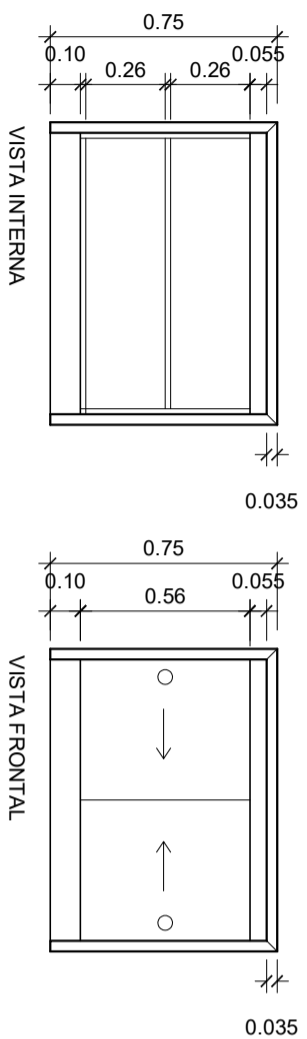

ARMÁRIO PRATELEIRA SEM PORTA esc.: 1/25

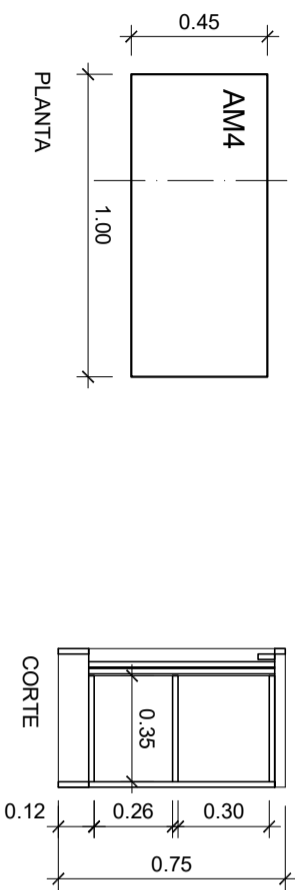
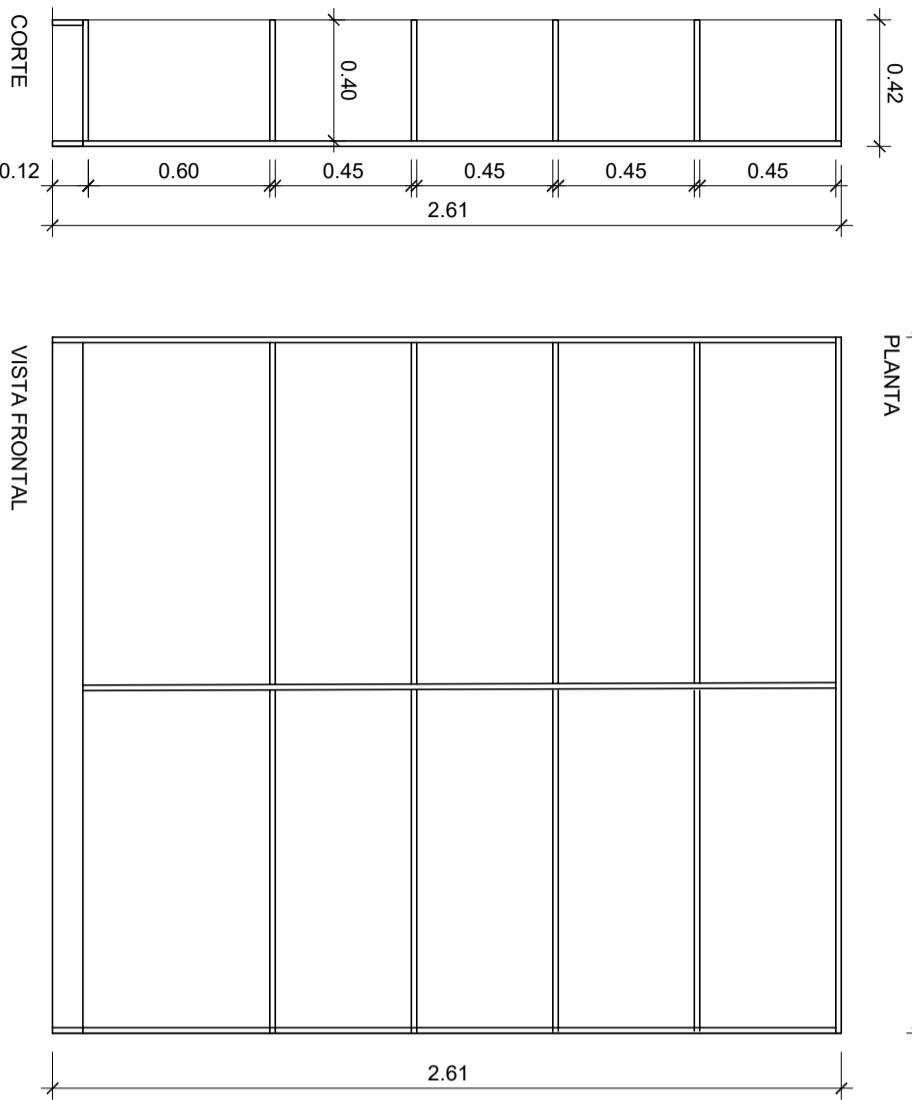
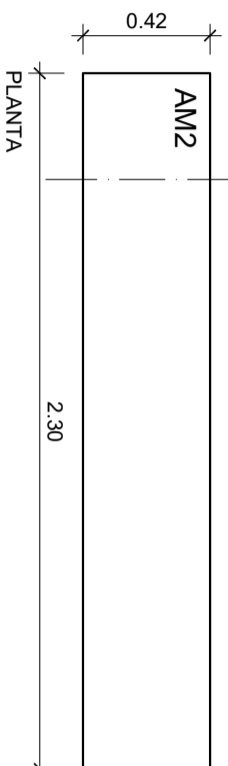

ARMÁRIO COM PORTA DE CORRER esc.: 1/25  
3.56

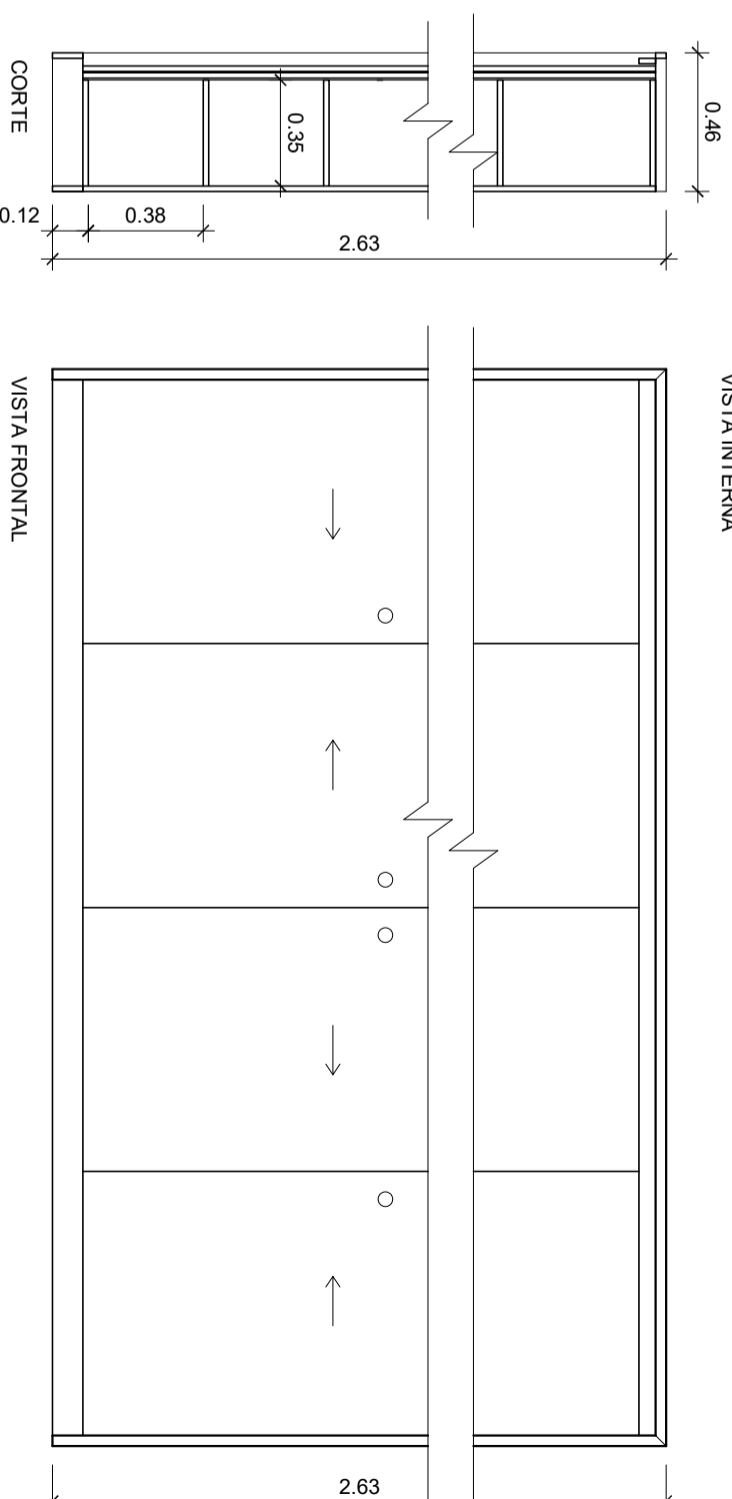
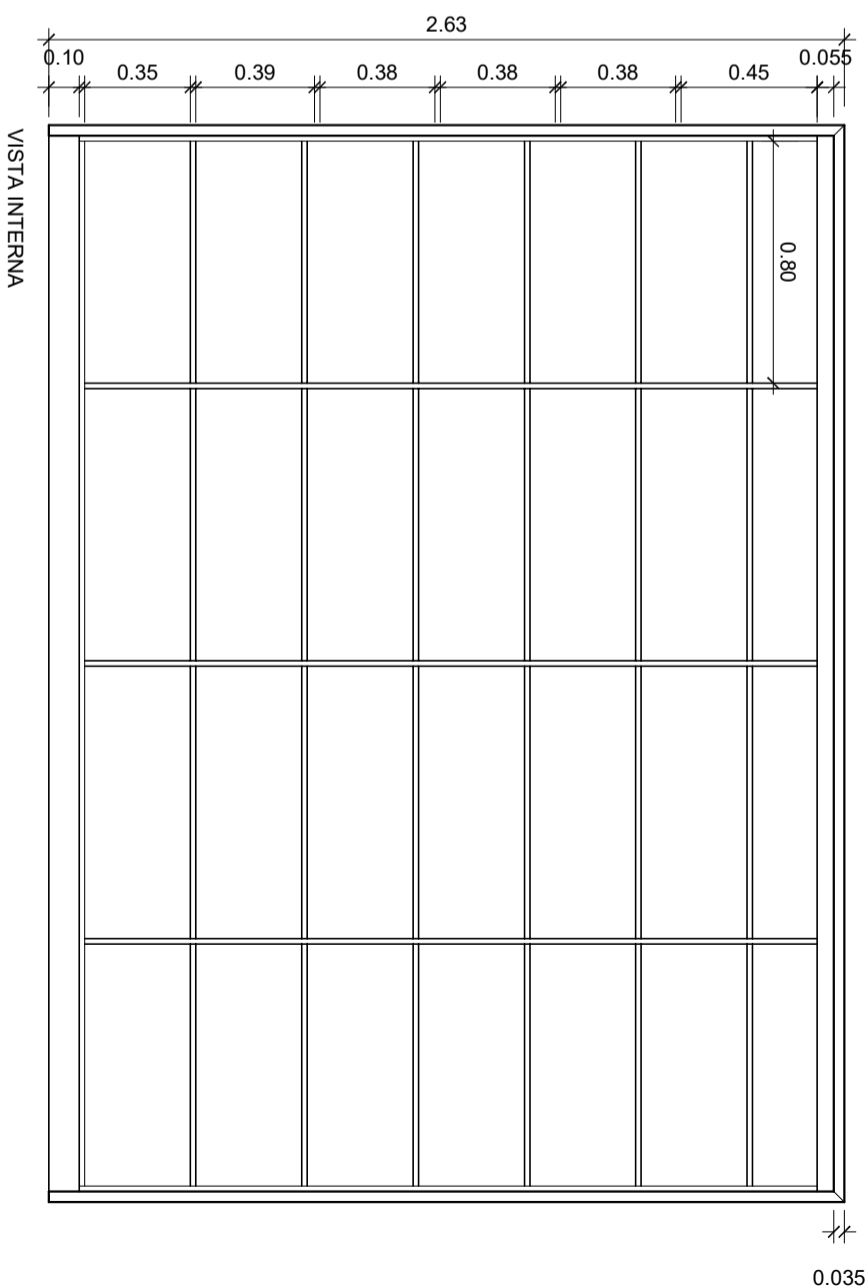
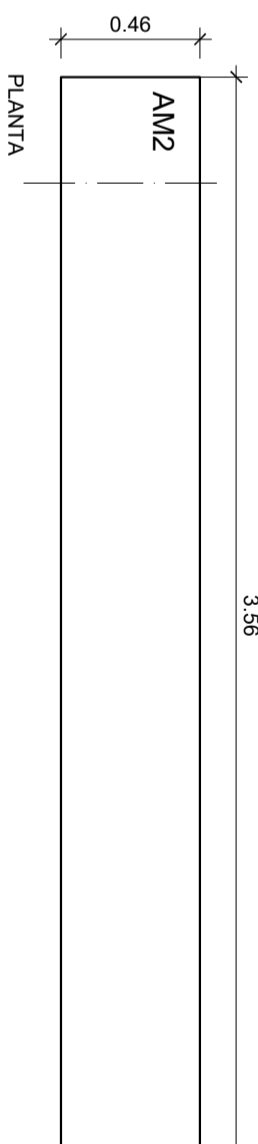

Responsável:  
**SECRETARIA MUNICIPAL DE PLANEJAMENTO DE TRANSPORTE E OBRAS**  
SERVIÇO DE PLANEJAMENTO URBANÍSTICO E HABITAÇÃO

Gerente:  
**RUBENS BLASZKOWSKI**  
Prefeito Municipal de Campo Alegre

Projetista:  
**FABIANO BICALHO**  
Arquiteto



Título:  
**PREFEITURA MUNICIPAL DE CAMPO ALEGRE - SC**  
MOBILIÁRIO - PLANEJAMENTO, TI E FISCALIZAÇÃO

Fase:  
AP

Data:  
03/08/2020

Escala:  
Indicada

Planilha:  
**02**